



## Three-Piece Ball Valve, Full Port, Sizes 1/4" ~ 4"



The SVF Series EZ6 full port ball valves were designed to provide a competitively priced, high performance product for general industrial applications. These valves feature a three-piece design for ease of maintenance and an integral locking device.

### SERIES EZ6 DESIGN FEATURES

- ✓ Designed & built for economical performance
- ✓ Pressure rated for 1,000 WOG
- ✓ Socket weld complies with ANSI B16.11
- ✓ Full Port flow path for maximum flow
- ✓ Three-piece "swing out" design offers easy access for in-line maintenance
- ✓ Blowout proof stem adds safety & reliability
- ✓ Lockable in the "Open" or "Closed" position

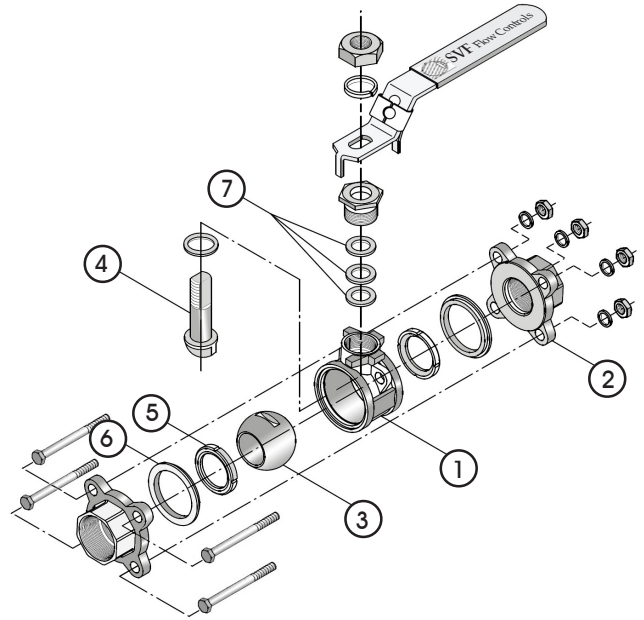
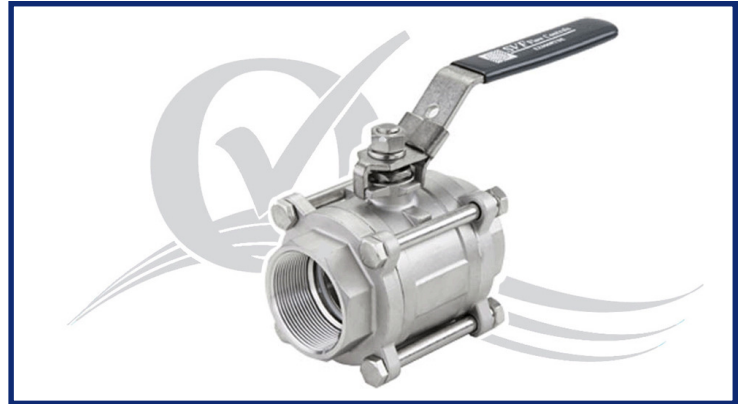

### MATERIALS OF CONSTRUCTION

ITEM	DESCRIPTION	MATERIALS SPECIFICATIONS
1	Body	316 Stainless Steel (ASTM A351 CF8M) Carbon Steel (ASTM A216 WCB)
2	End Connector	316 Stainless Steel (ASTM A351 CF8M) Carbon Steel (ASTM A216 WCB)
3	Ball	316 Stainless Steel (ASTM A351 CF8M)
4	Stem	316 Stainless Steel (ASTM A276)
5	Seat	RTFE
6	Body Seal	PTFE
7	Stem Seal	PTFE

### SERIES "EZ" FOR AUTOMATION

The SVF Series *EZ6* product line is designed for manual operation.

For automated versions of our "EZ" line of ball valves, please refer to our Series *EZ9*, which features direct-mounting of pneumatic and electric actuators.

Contact SVF for specific applications

What do you need today?™

HIGH PURITY  
**CleanFLOW**  
www.CleanFLOW.net

**PRO-SPEC**  
PROCESS SPECIFIC  
www.PRO-SPEC.NET

**QUALITY FLOWS THROUGH US**

## Three-Piece Ball Valve, Full Port, Sizes 1/4" ~ 4"



### DIMENSIONS, WEIGHT, Cv

Size	A		B		D		L		Weight.		Cv
	in.	mm	in.	mm	in.	mm	in.	mm	lbs	kg	
1/4"	2.56	65	0.46	12	4	99	2.3	58	1	0.5	12
3/8"	2.56	65	0.49	13	4	99	2.3	58	1	0.5	12
1/2"	2.56	65	0.59	15	4	99	2.4	61	1	0.5	12
3/4"	2.95	75	0.79	20	5	127	2.4	61	2	0.9	32
1"	3.35	85	0.98	25	6	152	3.0	76	2	0.9	57
1-1/4"	3.98	101	1.26	32	6	152	3.2	81	4	1.8	80
1-1/2"	4.41	112	1.50	38	8	203	3.9	99	6	2.7	104
2"	5.12	130	1.97	50	8	203	4.3	109	8	3.6	240
2-1/2"	6.38	162	2.48	63	10	254	5.4	137	15	6.8	320
3"	7.40	188	2.99	76	10	254	5.7	145	21	9.5	580
4"	8.82	224	3.78	96	13	330	7.1	180	42	19	2400

### EZ6 - PRESSURE/TEMPERATURE CHART

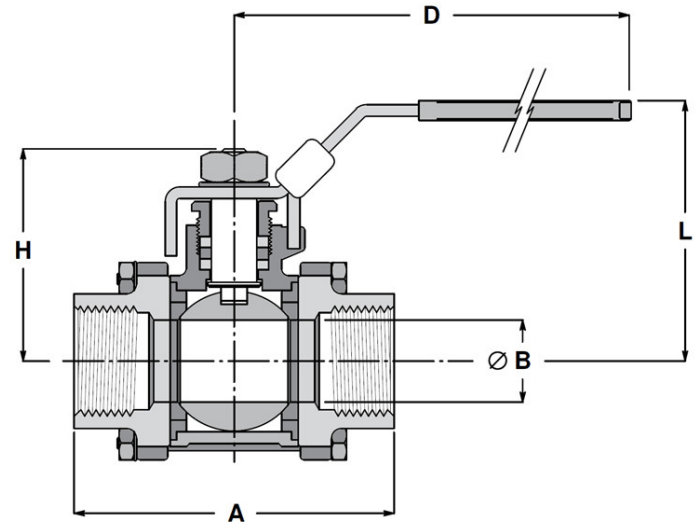
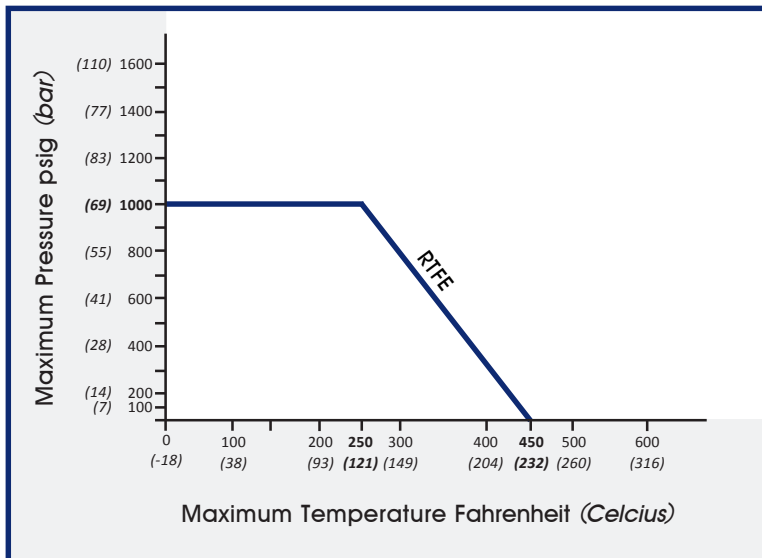

### HOW TO ORDER SERIES EZ6 BALL VALVES

SERIES	BODY & END MATERIAL	BALL & STEM MATERIAL	SEAT	BODY SEAL	ENDS	SIZE
EZ6	4 = Carbon Steel ASTM A216 WCB  6 = 316 Stainless Steel ASTM A351 CF8M	6 = 316 Stainless Steel ASTM A351 CF8M Ball A276 316 Stem	R = RTFE	T = PTFE	SE = Screwed Ends (FNPT)  SW = Socket Weld Ends (1/2" ~ 4" Only)	02= 1/4"    12= 1-1/4" 03= 3/8"    15= 1-1/2" 05= 1/2"    20= 2" 07= 3/4"    25= 2-1/2" 10= 1"      30= 3" 40= 4"
<b>Order Example: (EZ646RTSE05)</b>						
<b>Example Description: Carbon Steel Body &amp; Ends, Stainless Steel Ball &amp; Stem, RTFE Seat, PTFE Body Seal, Screwed Ends (FNPT), 1/2" Size</b>						
EZ6	4	6	R	T	SE	05